

EXAM SITE INFORMATION FOR DENTAL BOARD CANDIDATES



SCHOOL OF DENTAL MEDICINE

WESTERN REGIONAL EXAMINING BOARD

MAY 15-18, 2020

Welcome to Universidad de la Salle Bajío, College of Dental Medicine

The college is located at Blvd. Juan Alonso de Torres 3602, León, Guanajuato, Col. San Cayetano de Medina, Leon Gto. 37458. This handbook has been prepared to assist dental candidates for the Western Regional Examining Board Exam (WREB). If additional information is needed after reading this handbook, please contact (477) 7197611 ext 2204 .

Travel and Housing Arrangements

1. Airlines and Airport information

The airport near the city of Leon is the Bajío International Airport (BJX) which receives international flights from the USA from the airlines: DELTA, AEROMEXICO, AMERICAN AIRLINES, UNITED AIRLINES, INTERJET, VOLARIS, VIVA AEROBUS from the cities of: Sacramento, San Francisco, Atlanta, Houston, Chicago, Los Angeles, Dallas and Tijuana

2. Ground transportation from International Airport of Bajío.

- There are several car rental companies at the Bajío International Airport:

Avis

Phone: 800 770 2847

Alamo

Phone 800 849 8001

Hertz

Phone: 800 709 5000

Sixt Renta de Autos

Phone: 477 711 5577

Mex Rent a Car

Phone: 33 4170 8243
National Car rental
Phone: 472 748 2043

Europ Car
Phone: 477 713 1262

- There is the option of transportation by Taxi to any part of the city of Leon
- There is also the option of transport by shuttle specific terminals of the city

3. Housing

Reservations should be made directly with hotels/motels. Some hotels/motels are listed below:

HS HOTSSON Hotel Leon

Boulevard Adolfo Lopez Mateos 1102 Ote,
Col. Los Gavilanes,
León, Gto 37266
Mexico.
+52 477 719 8000

- **Radisson Poliforum Plaza Hotel Leon**

Boulevard Adolfo Lopez Mateos #2611 Oriente , Col Barrio de Guadalupe, León ,
Gto. 37280
México
+52 01 877 231 0729

- **Hampton Inn by Hilton Leon Guanajuato**

Boulevard Adolfo Lopez Mateos 1717
Colonia Los Gavilanes,
León Gto. 37270
México
+52 477 740 3200

- **NH Collection Leon Expo**

Prol. Boulevard Adolfo Lopez Mateos 2303
León Gto. 37270
México
+52 55 1168 9905

- **Holiday Inn Suites Leon Plaza Mayor**
Adolfo Lopez Mateos Poniente 2619
Col Predio El Juncal
León Gto. 37180
México
+52 800 841 9337
- **Courtyard by Marriot Leon Poliforum**
Blvd. Francisco Villa 102
León, Gto 37510
México
+52 477 2959400
+1 800 0011415

4. University De La Salle Bajio, Campus Juan Alonso de Torres

- Clinica Internacional de Odontologia
Blvd. Juan Alonso de Torres 3602
Col. San Cayetano de Medina
Leon Gto. 37458
Mexico
- The clinics where the exam is performed are **Clinic A**, **Clinic B** and **Clinic C** and are located on the ground floor of the building
- The Endodontics and Prosthodontics exams will be held in the **Sim Laboratory**, located on the first floor of the building
- The building opens at 7:00 am and closes at 7:00 pm for candidates during the WREB exam

5. Parking

- There are two (2) parking lots available for candidates, patients and assistants within the campus facilities. The first in front of the clinic building and the second in front of the facade of La Salle High School. Both are free but require identification if you are not a student or employee of the University

6. Registration and identification badges

- ID badges will be issued by WREB during candidate orientation and will serve as an ID throughout the examination and must be worn at all times while the candidate is in the building.
- Prior to the examination, you will receive a link to a secure website to upload your patient digital radiographs for storage on MiPACS server during the examination. This login information is also required to process and upload your digital radiographs taken during the endodontic portion of the examination. Please keep this information in a safe place.

7. ATM machines.

- There is an ATM machine located outside the SORIANA shopping center next to the University building.

8. Food service.

- There are no coffee vending machines inside the international clinic building.
- There is a dinner area that has a microwave on the first floor of the building. No coffee or food is allowed in clinical or laboratory areas

9. Provisional Acceptance

University of De La Salle School of Dentistry is a participant in the Provisional Acceptance program provided by WREB. All internal and external candidates are encouraged to use this program to facilitate their exam process. External candidates will receive email instructions to upload their patient information and radiographs via secure website approximately mid/January. All provisional acceptance submissions are due **4:30 pm, Tuesday, April 28, 2020** to ensure adequate processing time for transmission to WREB.

10. Patient Screening and radiographs

University of De La Salle cannot provide patients for candidates. Candidates are not permitted to inquire the college to obtain patients or patients records. It is highly recommended that all candidates secure their patients for examination procedures well before the examination along with any necessary radiographs. However, in the event that this is not possible, all candidates may use the dental school to screen patients, including use of radiology facilities for limited time prior to the examination. These screenings can be

performed in the Clinic A or B. Screening patients and candidates must sign a waiver of liability prior to usage of clinic facilities. Any radiographs taken on a potential patient require authorization of Dental School faculty member assigned to the screening area. Instructions will be provided for candidates on taking digital radiographs. Candidates are expected to take their own radiographs when screening patients at De La Salle University. No assistance will be provided. There will be a usage fee of \$50 per patient.

University De La Salle does not provide any facilities and/or equipment to process or view conventional radiographs. Please refer to the WREB Candidate Guide for information in the use of conventional radiographs during the clinical exam. The Clinic uses digital radiography acquired with storage phosphor plates (Soredex Optime) only.

Candidates planning to submit conventional radiographs for any portion of the exam (with the exception of the Endodontic working and treatment radiographs) should refer to the WREB and/or the WREB Candidate Guide for guidelines.

Endodontic working and treatment radiographs during the examination will be taken and submitted digitally. University De La Salle will provide all equipment and supplies necessary to take Endodontic working and treatment radiographs during the Endodontics examination.

All digital radiographs for use during the examination that have not been taken through patient screenings at University De La Salle must be submitted electronically (via secure website) to the college seven days prior to the exam in order to be transferred into MIPACS database. Absolutely no electronic submissions will be accepted after 4:30 pm PST on April 28, 2020.

Radiology will be available during the same hours as screening, but very limited (emergency) access will be available during the WREB exam.

Screening and radiology for candidates will be permitted on an appointment basis only between the business hours of 10:00 a.m. until 3:00 p.m. Monday through Friday during the following period: May 4-8, 2020.

11. Preparing for the Exam

1. Clinic Operatories

Each candidate will be assigned a clinical operatory by the WREB, which will correspond to the Candidate's ID badge issued at orientation. Each operatory is equipped with (1) dental chair (PROMA A series), (1) delivery unit, (1) operator chair, and (1) assistant chair. Any equipment malfunctions should be reported to maintenance staff. Candidates will be allowed to move in to the assigned operatories at a time to be determined by the WREB. Please note: Cabinets are not available for storage. However, clinics are secured before and after exam hours.



2. Equipment, Instruments and Materials

Items supplied by the school are listed in the supplemental section at the end of this handbook.

a. Equipment Rentals

De La Salle does not provide equipment rentals to candidates. Candidates must bring their own equipment and handpieces. Sterilization services are provided to candidates for their instruments and handpieces. Please see the section entitled “Sterilization” for further details.

b. Handpieces

All PROMA A series dental chairs (including Endo examination simulation units) are equipped with connectors for high speed and slow speed handpieces, respectively.

Connector 4 holes



Please note that while standard 5 high speed handpieces will fit in the receptacle for the connector, the water supply has been disabled permanently for this connection. Candidates should also be aware that the connector does not have a fiber optic light source. Universidad de La Salle does not offer any assistance for candidates attempting to use unsupported connections.

Adaptors/ couplers are available. Please be sure you have the required handpieces.

c. Ultrasonic Scalers

All dental units are equipped with quick-connect water sources and are compatible with Dentsply SPS and/or most Dentsply cavitron units.



d. Amalgamators

Several Kerr Optimix amalgamators are available for use throughout the entire exam clinic. If you plan on using these amalgamators, please verify its location in the clinic prior the exam. These amalgamators are available to use for all candidates and are not be moved. Please observe all infection control protocols when using these amalgamators.

e. ModuPro for Endodontics and Prosthodontic Exam

The WREB endodontics examination will use the ModuPro Endo model #MP-E120-PC. The WREB prosthodontics examination will use the ModuPro One model #MP-R320. If candidates are taking both the Endodontics and Prosthodontics exams, the ModuPro One gums and endodontic sextants are interchangeable with the ModuPro magnetic carrier trays and articulator. Please order all applicable items form Acadental al www.acadental.com/WREB and bring them with you since the college does not have any to rent. Please contact Acadental for assistance in obtaining any items required for the endodontics exam.

f. School Store

University de La Salle does not have a school store.

Instruments that belong to you should be properly cleaned, dried, bagged, and marked with appropriate candidate ID and name. Bagged instruments should then be turned in at the 1st. floor central sterilization. Sterilization time is a minimum of 3 hours.

Sterilization services are available between 8:00 am and 5:00 pm. As stated above, there is a minimum turnaround time of 3 hours for personally owned items.

12.- During the board

Infection control protocols

a) Surface asepsis

- The switch and handles of the unit, light, dental unit handles and operator control pads must be covered with barrier tape (provided). Air/water syringes and evacuators must be covered with clear plastic bags (provided)
- The dental unit, counter tops and dental chair should be disinfected with Pro-Spary wipes
- The patient chair should be covered with plastic bags (provided)

b) Personal protective equipment

- Appropriate clothing is required – scrubs, no open-toed shoes
- Disposable gowns, gloves and masks are provided and located in the clinic
- Candidates need to provide their own OSHA-compliant protective glasses. The school will provide protective glasses for patients on a “loan” basis
- Antiseptic soap is available at sinks in the clinic

c) Hazardous waste

- Any blood/saliva-soaked waste is considered hazardous and must be disposed of in biohazard bags and biohazard trash receptacles located throughout the clinic
- Biohazard bags may be attached

Sharps disposal

- All needles, anesthetic cartridges, blades and any other potential sharps are to be placed in the red sharps containers located under the counter of each cubicle.

13. Medical emergencies

In order to alert emergency personnel to a medical emergency and not unduly alarm the patient population, the following protocol must be followed upon discovering a serious medical emergency:

- a) The patient will remain in the care of the candidate or person discovering the problem. The patient must not be left alone. The assistant or responsible person will be sent to report the problem to the Floor Examiner.
- b) The examiner will have access to the school's automatic external defibrillator (AED) and provide appropriate action according to the American Heart Association (AHA) standards until emergency responders arrive.
- c) The assistant will be sent to the ground floor clinical dispensary for an emergency kit and a request that the dispensary staff place an immediate call for emergency personnel. If a "Code Blue" emergency has been declared, Dispensary personnel will immediately place call to 911
- d) In all possible emergencies:
 - Terminate the dental procedure
 - Notify the Floor Examiner
 - Position the patient – supine if unconscious
 - Perform the CABs of CPR
 - a) Circulation – check the pulse
 - b) Airway check – reposition airway as needed
 - c) Breathing check – rescue breaths or start CPR as needed.
- e) The examiner assumes responsibility for resuscitative procedures and the administration of emergency drugs until revived by other personnel

Exam Room Assignments.

Candidate Orientation

School Tour
de Torres

Clinic Exam Area (Ground Floor)

Endodontic and Prosthodontic Exam

Building and Room

Auditorium Juan Alonso de Torres

Outside of Auditorium Juan Alonso

Clinic A and B (Ground Floor)

Laboratory Sim Clinic (1st Floor)

Please refer to the official WREB schedule for specific days times.

14. Dental supplies

Items supplied by Clinical Dispensary (items not listed are responsibility of the candidate)

- Air-water syringe tip disposable
- Amalgam capsules
- Articulating paper
- Autoclave tape
- Biohazard bags
- Sterilization bags
- Trash bags
- Cement, temporary (Temp bond)
- Cement, permanent (RelyX Luting Plus)
- Cotton gauze / 2 x 2
- Cotton pellets
- Cotton swabs
- Cups, drinking
- Deck paper
- Disinfectant (Pro-Spary Wipes)
- Evacuator tips
- Face masks
- Facial tissue

- Floss
- Gloves
- Headrest-chair covers
- Hemostatic Agents (Hemodent, Viscostat)
- Impression materials (PVS)
- Impression trays, disposable
- Instrument trays, disposable
- Local anesthetic (lidocaine 2% 1:100,000 epinephrine, Articaina 4% epinephrine 1:100, 000, Mepivacaine HCL 3%, Septocaine)
- Mouthwash
- Napkins, patient
- Needles, short and long
- Paper towels
- Patient bibs
- Polishing materials
- Prophy paste
- Retraction cord
- Rubber dam
- Saliva ejectors
- Soap, hand
- Topical anesthetic
- Tray covers
- Digital radiographs via storage phosphor plates (Soredex Optime)

Items supplied in dental wet laboratory

- Mounting plaster
- Microstone

Items supplied for endodontics and prosthodontics exam:

- Air/water syringe
- Face masks
- Gloves
- Gowns
- Isopropyl alcohol wipes
- Rubber dam
- Sodium hypochlorite (bleach)
- Zip lock bag (from WREB)
- PVS material for putty matrices

Please note: candidates must provide their own endodontic files

15. Campus Maps

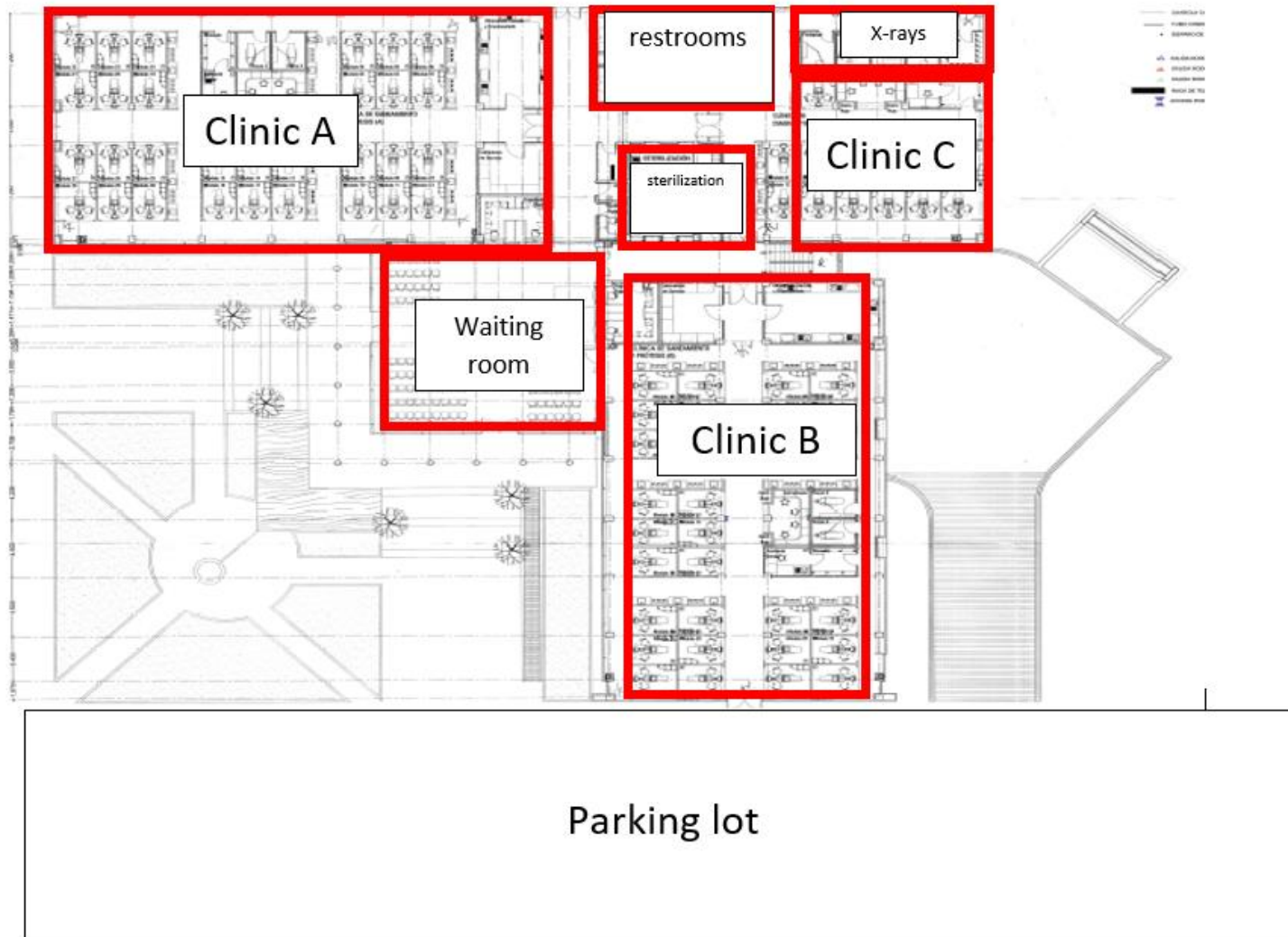



FIRST LEVEL

UNIVERSITY DE LA SALLE

